

livePACE[®] Pace T10[®] Pace T20[®]

**external
temporary
pacemakers**

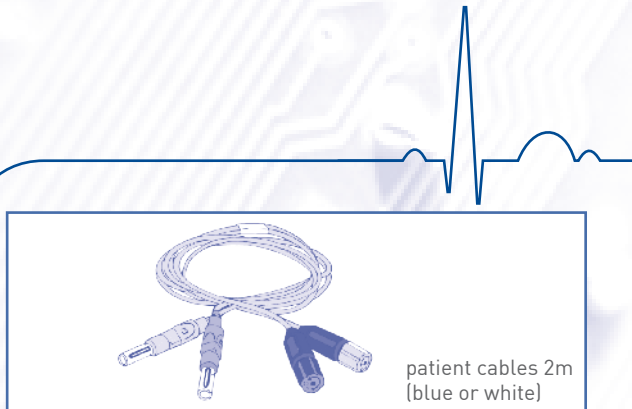

livePACE - technical parameters



technical parameters Pace T20[®]

amplitude 0.1 – 20 V / dual chamber
pulse duration: atrium: 0.7 ms ventricle: 0.5 ms
high rate: 1ms
sensitivity atrium: 0.1 mV – 20 mV / ventricle: 1 mV – 20 mV
pulse rate 30 – 250 ppm / high rate 40 – 1000 ppm
presetting 400 ppm burst (8 pulses) or permanent stimulation backup (VVI, 40 ppm) stimulation at ventricle A emergency V00/10 V/80 ppm
refractory time atrium 400 ms – 200 ms for AXX modes (depending on pulse rate)
TARP for all dual-chamber modes
refractory time ventricle 250 ms – 200 ms for VXX modes (depending on pulse rate) 225 ms – 175 ms for all dualchamber modes (depending on pulse rate)

AV-delay (AV-Dly) 15 ms – 300 ms
automatic settings (depending on pulse rate) or manual
automatic: 50 until 300 ms (min. 50 ms)
manual: 15 until 300ms

PV-delay (PV-Dly) 15 ms – 250 ms (AV-Dly * 0.84)

PVARP 100 – 500 ms automatic settings (depending on pulse rate) or manual
automatic: TARP - AV-Dly manual: 100 – 500ms

start mode selectable / storable
weight: 365 grams

livePACE - technical parameters

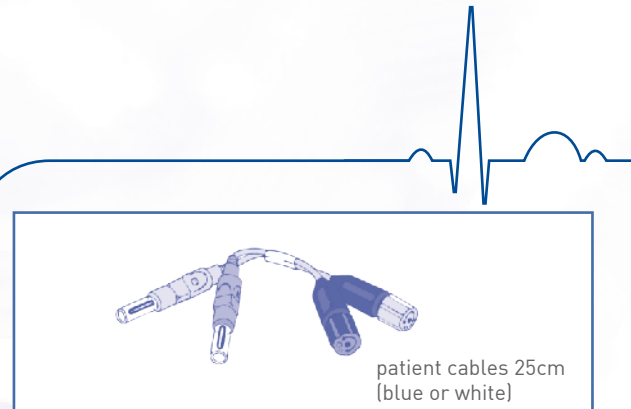

technical parameters Pace T10[®]

see (single chamber) parameters of Pace T20[®] except:
0.7 ms for AXX modes 0.5 ms for VXX modes
refractory time atrium 400 ms – 300 ms for AXX modes (depending on pulse rate) / ventricle 250 ms for VXX modes, start mode selectable / storable
weight: 285 grams

safety features Pace T10[®] & Pace T20[®]:

run away protection, depending on pulse rate setting
noise detection level 1 (display: noise warning): noise frequency > about 8.3 Hz (120ms) level 2 (change to a fixed-frequent stimulation): noise frequency > about 14 Hz
warnings short-circuit, open electrode accesses high/low impedance, pulse rate (> 150 ppm) EOL (battery and backup battery) noise self test and system error

CE approval: class IIb products

all products are made in Germany

engineered & manufactured by:

livetec Ingenieurbüro GmbH
Marie-Curie-Straße 8
79539 Lörrach
Germany
www.livetec.de

living technology for life

livePACE® | single or dual chamber external temporary pacemakers

Pace T10®



intended use

the PACE T10® and Pace T20® is intended for a temporary application (< 30 days) at patients as follows:

- at pre-operative and operative stimulation of the patient before an implantation or during exchange of an implantable pacemaker
- during and after a heart surgical treatment.
- for temporary therapy of bradycardia or tachycardia
- for therapy of dysrhythmia for certain myocardial infarction
- during an external emergency stimulation

depending on the chosen stimulation mode pacing and sensing (detection) occurs by transvenous applied atrial and/or ventricular pacing electrodes or myocardial heart wires

all electrodes or heart wires with diameter from 0.9 mm to 2.1 mm are suitable for the application

Pace T20®



significant product features

single and dual chamber external temporary pacemakers

T10 modes:

A00, AAI, AAT, V00, VVI, VVT, high rate, emergency, OS0

T20 modes:

A00, AAI, AAT, V00, VVI, VVT, DDD, DDI, DVI, DAI, D00, DDT, VDD, VAT, high rate, emergency, 0D0

direct **high rate** mode 400ppm
selectable switch on mode

automatic slow down **high rate** to defined heart rate

automatic and manual programming of TARP, AV-delay, PVARP and MTR

touch screen system, easy to use, self-explanatory
easy locking of functions against unintended use
very small effort for cleaning and disinfection

protection cover

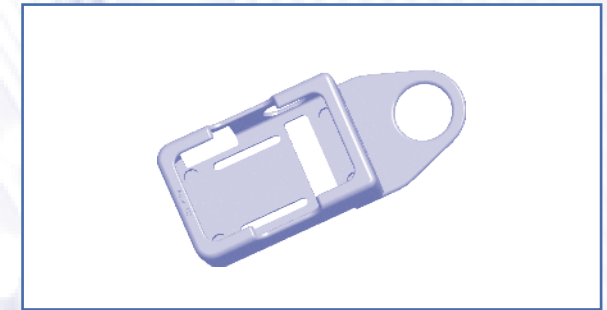

significant product features

single and dual chamber external temporary pacemakers

- up to 20V output / digital precision
- electrically isolated outputs (real floating)
- biphasic pulse neutralize electric charge on the electrodes
- standard AA size batteries (2pcs.)

backup battery system allows a stress-free replacement of the batteries during pacing

collet range: 0.9 - 2.1 mm

patented overwind protected ® collets
patient cables, re-sterilizable up to 25 times

defibrillator protection 5kV
energy-saving and illuminated LCD
operating time: T10 >200h / T20 >150h

protection cover for rough usage
easy fixable to patient or bed